

TECHNICAL DATA

SINGLE DIRECTION VIBRATORY PLATES

BVP 10/30, BVP 12/50 A



Handling

47 kg lightweight (BVP10/30)
72 kg lightweight (BVP12/50A)



Performance

Fast running and simple handling



Costs

Maintenance free exciter (BVP10/30)

Shipping dimensions in m3

BVP 10/30

0,212

BVP 12/50 A

0,312

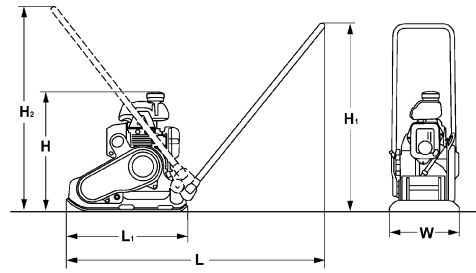

Standard Equipment

- Vibration insulated steering handle (BVP10/30)
- Detachable steering handle
- Highly wear resistant base plate (BVP10/30)
- Highly wear resistant cast iron base plate (BVP12/50A)
- Automatic shutdown at low oil level (BVP12/50A)
- Recoil starter
- Single point lifting device
- Fully protected V-belt
- Carrying handles
- 3-2-1 Warranty
- Sprinkler system (BVP12/50A)

Optional Equipment

- Special painting
- Plastic mat (BVP10/30)
- Service Kit
- TOUGH WARRANTY (BVP12/50A)
- Comfort guide handle (BVP10/30)

Dimensions in mm

	H	H1	H2	L	L1	W
BVP 10/30	489	840	930	1058	509	300
BVP 12/50 A	660	940	820	970	530	500

Technical Data

Weights

Operating weight CECE	kg	47	72
Basic weight	kg	46	67

Dimensions

Working width	mm	300	500
---------------------	----	-----	-----

Driving Characteristics

Working speed, max.	m/min	25	25
Max. gradeability (dep. on soil con.)	%	30	30

Drive

Engine manufacturer	Honda	Honda	
Type	GXR 120	GX 120	
Emission stage	Stage V / CARB P.3	Stage V / CARB P.3	
Cooling	air	air	
Number of cylinders	1	1	
Performance SAE J 1349	kW	2,1	2,6
Speed	min-1	3.600	3.600
Drive system	mech.	mech.	
Fuel	Gasoline	Gasoline	
Fuel consump. aver. during operation	l/h	0,6	0,9

Exciter system

Frequency	Hz	100	92
Centrifugal force	kN	10	12
Amplitude	mm	1,34	1,10

Capacities

Fuel	l	0,8	2,0
Water	l	-	7,0

Technical modifications reserved. Machines may be shown with options.



PRE 834 19 010

090222 Sa05

BOMAG
 Hellerwald
 D-56154 Boppard
 P.O. Box 5162
 Tel. (0)6742 - 1000
 Fax (0)6742 - 3090

